

# 19'-22' X 8' HIGH ALUMINUM SLIDE GATE

## (ASG-228) (ASG-BW22)

GATE PART #

BARBWIRE PART #

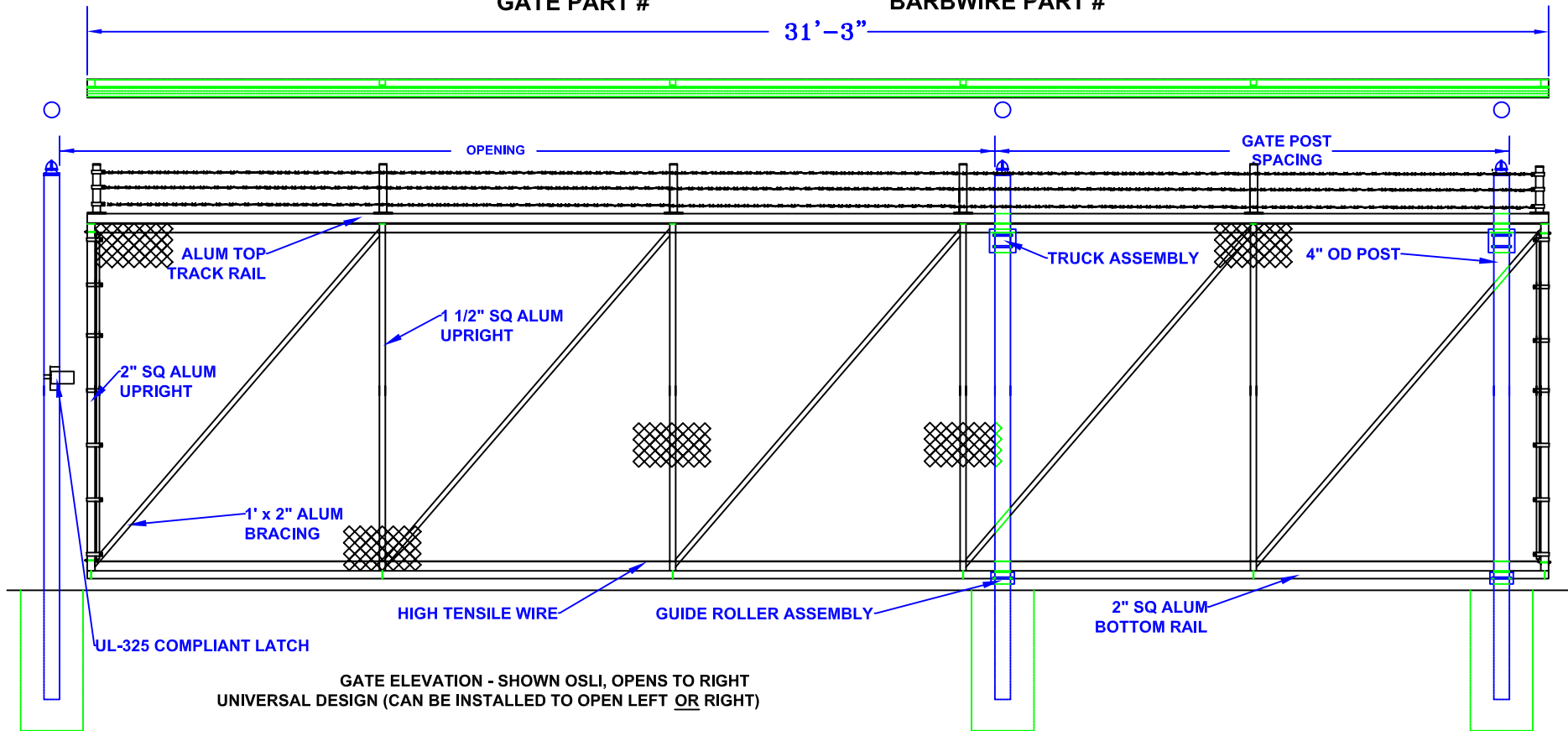

**Notes:**

1. SPECIFICATIONS CAN BE CHANGED BY SHARON FENCE COMPANY ONLY.
2. FOOTING TO BE (4)X POST WIDTH. MIN DEPTH TO BE 36" [914 MM].
3. GATES MAY BE MANUALLY OR ELECTRICALLY OPERATED. HARDWARE WILL VARY.
4. GATES TABULATED ARE UL-325 COMPLIANT.
5. GATES ARE UNIVERSAL (OPEN TO LEFT OR RIGHT).
6. TOP TRACK AND RAIL; ENCLOSED 1-PC ALUMINUM (6061-T6) EXTRUSION (3.83 LBS PER LF)
7. 1" X 2" ALUMINUM DIAGONAL BRACING WELDED TO 2" SQUARE ALUMINUM UPRIGHTS.

**OPENING**

19'  
20'  
21'  
22'

**GATE POST SPACING**

12'-0"  
11'-0"  
10'-0"  
9'-0"

Approved By: \_\_\_\_\_

Date: \_\_\_\_\_